



FRESH AND SUBTLE CHANGES FURTHER ENHANCE THE INTERNAL DÉCOR OF THE HUGELY POPULAR WINCHESTER. CONTEMPORARY STYLING IS TEAMED WITH A WIDE RANGE OF FEATURES, GIVING INNOVATIVE LAYOUTS THAT PROVIDE FLEXIBLE ACCOMMODATION WITH A DISTINCTIVE DIFFERENCE

The 2012 Winchester is available with a separate lounge and dining area as standard or may be specified as an open-plan version for those who prefer free-flowing space.

The rich wood tones of the light and airy kitchen area are enhanced by a limestone effect vinyl flooring that leads the eye through to the spacious dining area with its elegant upholstered chairs and feature pendant lighting.

In addition to the en-suite toilet, the main bedroom of the two bedroom model includes a large dressing table with stool and a lavish window seat from which to watch the world go by.

The modern family bathroom in the two bedroom version includes a bath with shower which also boasts a large storage unit and vanity mirror.

At twelve foot six inches wide, the unique Winchester is a stylish choice that combines luxury with a spacious feel that is exaggerated by clever design and impressive, carefully selected complementary furnishings.

## WINCHESTER FEATURES

### EXTERIOR/STRUCTURE

- Energy efficient white PVCu double glazed windows and doors
- Aluminium cladding (option 'Sand' vinyl cladding)
- Fully galvanised 'Fusion' chassis (see page 62 for more details)
- Steel pantile pitched roof
- Underfloor insulation and lagged water pipes
- Modern gutters and fall-pipes
- Exterior light

### INTERIOR FEATURES

- Gas combi boiler central heating system incorporating radiators with temperature control valves
- Secluded Lounge layout
- Voile curtains (excludes kitchen and shower room)
- Vaulted ceilings
- Energy efficient lighting

### LOUNGE

- Freestanding three piece suite with fold-out occasional sofa bed and scatter cushions
- Flame effect electric fire
- Framed wall art
- Nest of tables
- Low-level freestanding TV cabinet with flat screen mount
- Display cabinet

### KITCHEN

- Integrated 70/30 fridge-freezer
- Gas combination oven with hob/grill and glass splashback
- Stainless steel cooker hood with extractor fan
- Limestone tile effect vinyl flooring

### DINING AREA

- Freestanding pedestal dining table
- Upholstered dining chairs
- Inset door mat

### MAIN BEDROOM

- Kingsize bed with lift-up storage system (two bedroom model)
- Double bed with lift-up storage system (three bedroom model)
- En-suite WC (two bedroom model)
- Window seat with ottoman storage (two bedroom model)
- Dressing table and stool (two bedroom model)
- Co-ordinating bedding set
- TV point linked to aerial booster

### TWIN BEDROOM(S)

- Space saving fold-under bed (one supplied in three bedroom model)
- Co-ordinating bedding sets
- TV point(s) linked to aerial booster

### FAMILY BATHROOM / SHOWER ROOM

- Bath with thermostat controlled shower over and glass shower screen (two bedroom model)
- One piece fibreglass shower enclosure with thermostat controlled shower (three bedroom model)
- Second separate WC (en-suite in two bedroom model)

### REGULARLY SPECIFIED OPTIONS

- Open-plan layout (standard layout: Secluded Lounge)
- 'Apex' Outlook French doors
- High performance rigid vinyl cladding
- Shower to replace the bath (two bedroom model)
- Integrated microwave
- Integrated washer/dryer
- Integrated slimline dishwasher
- 'Environmental green' exterior and window frames



TV, DVD player, MP3 player and speaker system not included



Available with optional Outlook French doors and as Open-plan or Secluded Lounge (standard) models  
TV, DVD player, MP3 player and speaker system not included

Optional Outlook French doors



Standard window model in optional rigid vinyl cladding





Toaster, microwave and coffee maker not included

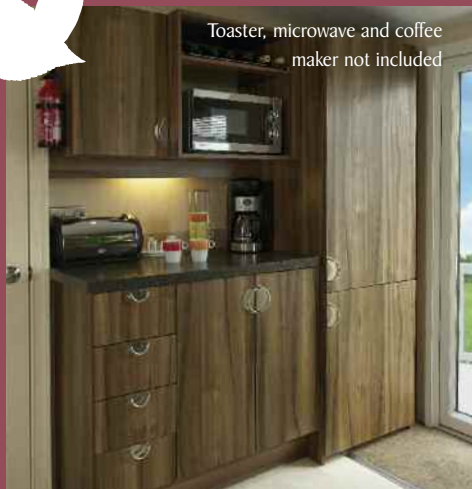

Toaster, microwave and coffee maker not included



Kettle not included





Family bathroom



Family bathroom

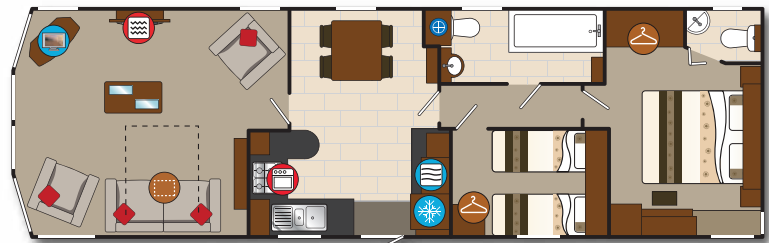

38 X 12' 6" 2 BEDROOM SLEEPS 6

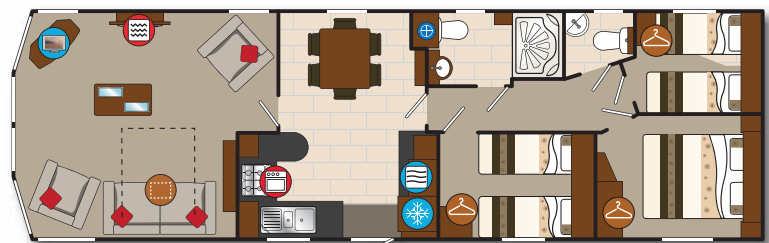

38 X 12' 6" 3 BEDROOM SLEEPS 8

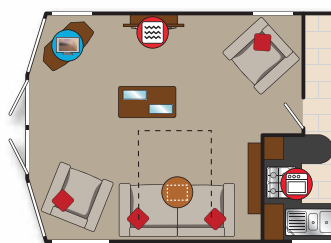

OUTLOOK

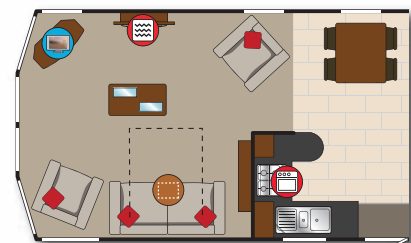

OPEN-PLAN

Both models available with Outlook French doors and as Open-plan or Secluded Lounge (standard) models

ICON KEY

-  TV Space
-  Electric Fire
-  Cooker
-  Microwave Space
-  Fridge-Freezer
-  Fold-out bed
-  Wardrobe
-  Boiler

Please refer to page 65 for the features/options comparison chart  
External dimensions can be found on page 67

