



DISCOVER THE TRUE MEANING OF LUXURY WITH THE VOGUE CONNOISSEUR. DESIGNED FOR THOSE WITH DISCERNING TASTES AND A KEEN EYE FOR DETAIL, THIS FLAGSHIP MODEL IS THE EPITOME OF COMFORT, QUALITY AND STYLE

Available as both a Secluded Lounge and Open-plan model, the Vogue Connoisseur boasts an extremely spacious and attractively appointed interior that uses rich cream, champagne and caramel tones to create a calming sanctuary in which to relax.

The lounge with its large three piece suite, flatscreen television and DVD system is a fantastic space in which to unwind.

The fully equipped kitchen features a host of integrated appliances and is finished with soft close white gloss doors and drawers, laminate flooring and slate effect work surfaces.

Opulence is carried through into the bedrooms – the signature two bedroom model features an angled kingsize bed, a generous walk-in wardrobe and plenty of innovative storage options. Also featured in this model are a full sized bath and a luxury en-suite shower room.

Classic styling and a wide range of stunning features put the Vogue Connoisseur beyond compare - quite simply it is the ultimate in holiday home design.

VOGUE FEATURES

EXTERIOR/STRUCTURE

- Energy efficient white PVCu double glazed windows and doors
- High performance rigid vinyl cladding
- Heavy duty galvanised chassis (twin axle)
- Superior Rockwool™ insulation
- 100mm external wall structure
- Steel pantile pitched roof
- Underfloor insulation and lagged water pipes
- Modern PVCu gutters and fall-pipes
- Exterior lights

INTERIOR FEATURES

- Secluded Lounge layout with sliding 'pocket' door system
- Gas combi boiler central heating system incorporating radiators with temperature control valves
- Energy efficient lighting

LOUNGE

- Wall mounted 37" LCD TV
- Digital DVD recorder with built-in hard drive
- Freestanding three piece suite with fold-out occasional sofa bed and scatter cushions
- Flame effect electric fire
- Coffee table with magazine shelf
- Wall-mounted mirror

KITCHEN

- Integrated appliances: 70/30 fridge-freezer, washer/dryer* and microwave oven/grill
- High-level dual oven/grill
- 5 burner hob with wok burner and auto ignite
- Chrome and curved glass cooker hood
- 'Soft close' high gloss cabinet doors and drawers
- 1½ bowl linen finish stainless steel sink
- Slate effect worktops and upstands
- Laminate flooring
- LED plinth lighting system
- Concealed fold-out ironing board

DINING AREA

- Freestanding dining table
- High-backed dining chairs
- Feature vaulted ceiling canopy

MAIN BEDROOM

- Unique corner bed layout (two bedroom model)
- Kingsize bed with concealed under-bed and headboard storage areas (two bedroom model)
- Double bed with lift-up storage system (three bedroom model)
- En-suite shower room with WC (two bedroom model)
- Walk-in wardrobe (two bedroom model)
- Co-ordinating bedding set
- Flat-screen TV point with bracket

TWIN BEDROOM(S)

- Space saving fold-under bed (one supplied in three bedroom model)
- Co-ordinating bedding sets
- Flat-screen TV point with bracket

FAMILY BATHROOM/SHOWER ROOM

- Full-sized bath with thermostat controlled shower over and glass shower screen (two bedroom model)
- One piece fibreglass Quad shower cubicle with thermostat controlled shower (three bedroom model)
- Dual flush, silent fill WC
- Extractor fan

EN-SUITE (TWO BEDROOM MODEL ONLY)

- 800 x 800 one piece fibreglass shower unit with thermostat controlled chrome shower and bi-fold doors
- Dual flush, silent fill WC

REGULARLY SPECIFIED OPTIONS

- Open Plan layout (standard layout: Secluded Lounge)
- Outlook French doors (standard layout: front windows)
- *Dishwasher in place of washer/dryer
- Woodland Vogue model (natural timber cladding)
- 'Environmental green' exterior and window frames



Available with optional Outlook French doors and open-plan layout





Kettle and toaster not included



Iron and toaster not included





TV not included



Family bathroom



Family shower room (3 bedroom model)

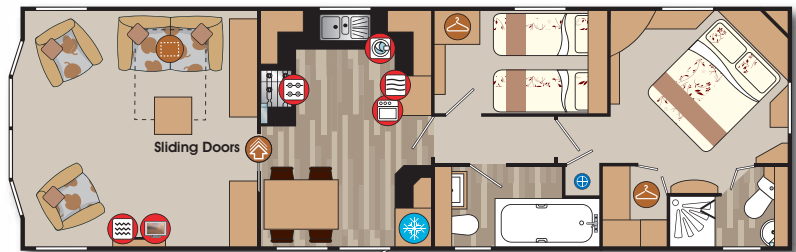

42 X 13 2 BEDROOM SLEEPS 6

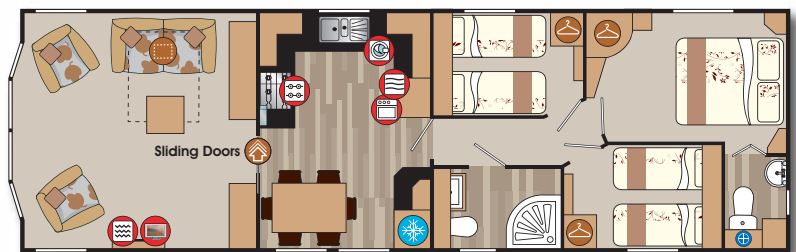

42 X 13 3 BEDROOM SLEEPS 8



OUTLOOK

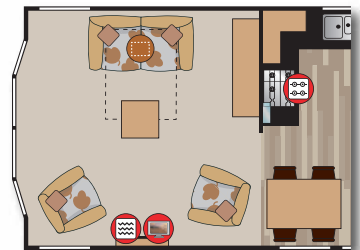

OPEN-PLAN

Both models available with Outlook French doors and as Open-plan or Secluded Lounge (standard) models

ICON KEY

- TV
- Electric Fire
- Washer/Dryer
- Cooker
- Microwave
- Hob
- Fridge-Freezer
- Fold-out bed
- Wardrobe
- Sliding Doors
- Boiler

Please refer to page 65 for the features/options comparison chart
External dimensions can be found on page 67

